

Suitable for: 64mm & 92mm Steel Stud, 13mm Gib Linings,
 incl Glazing profiles

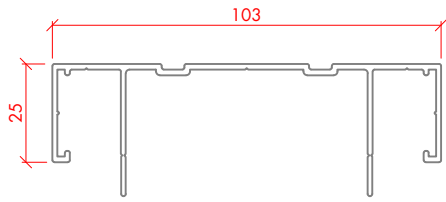

64mm GROOVED HEADSECTION
 PSL 400

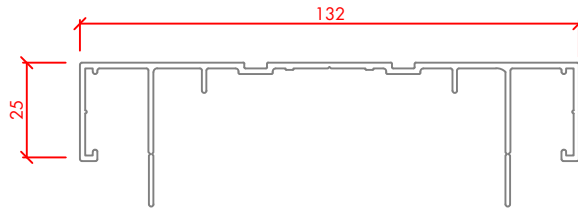

92mm GROOVED HEADSECTION
 PSL 420

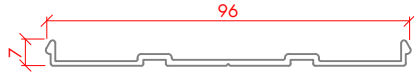

GROOVED STARTER CAP
 PSL 125

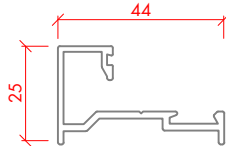

GLAZING BAR-STANDARD
 PSL 205

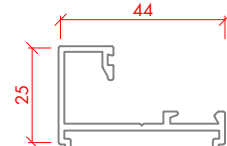

GLAZING BAR WITH LEGS
 (GLAZING BAR 2)
 PSL 210

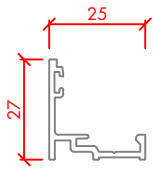

GLAZING BAR
 PSL 540

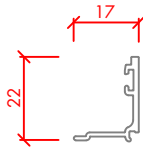

GLAZING BEAD
 PSL 541

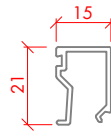

GLAZING BEAD
 PSL 215

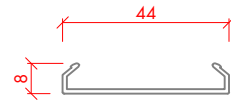

GLAZING FLUSH CAP
 PSL 220

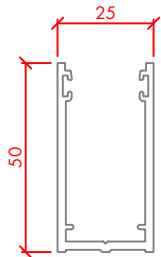

GLAZING CHANNEL
 PSL 542

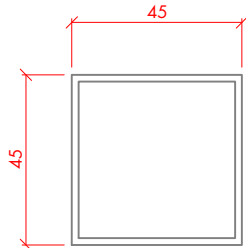

BOX SECTION
 PSL 300

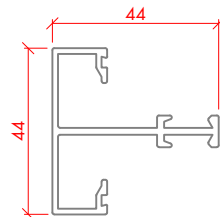

GLAZING MULLION
 PSL 225

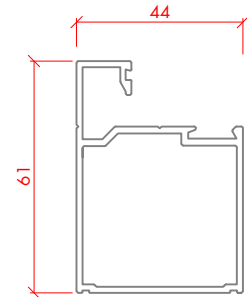

DOOR PILLAR POST
 PSL 315

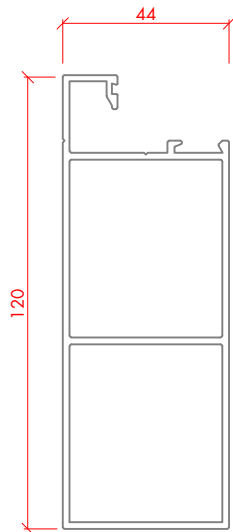

BOTTOM GLAZING BAR
 PSL 680

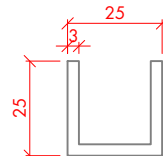

25 X 25 X 3 CHANNEL
 PSL 320

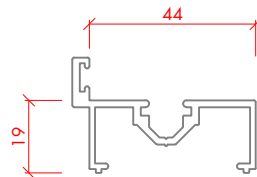

DOOR JAMB-STANDARD
 PSL 305

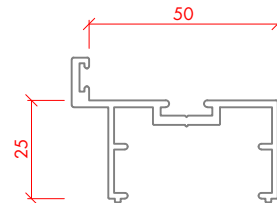

DOOR JAMB-50mm DOOR
 (DOOR JAMB 2)
 PSL 310

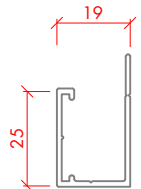

GIB LINING CAP
 PSL 325

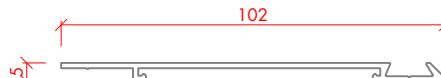

100mm SKIRTING
 PSL 601

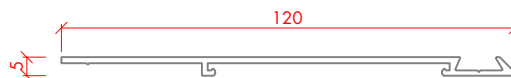

120mm SKIRTING
 PSL 356

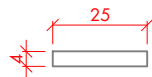

FLAT BAR
 PSL 130

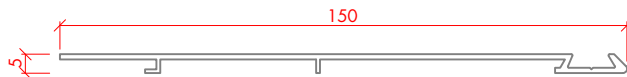

150mm SKIRTING
 PSL 602

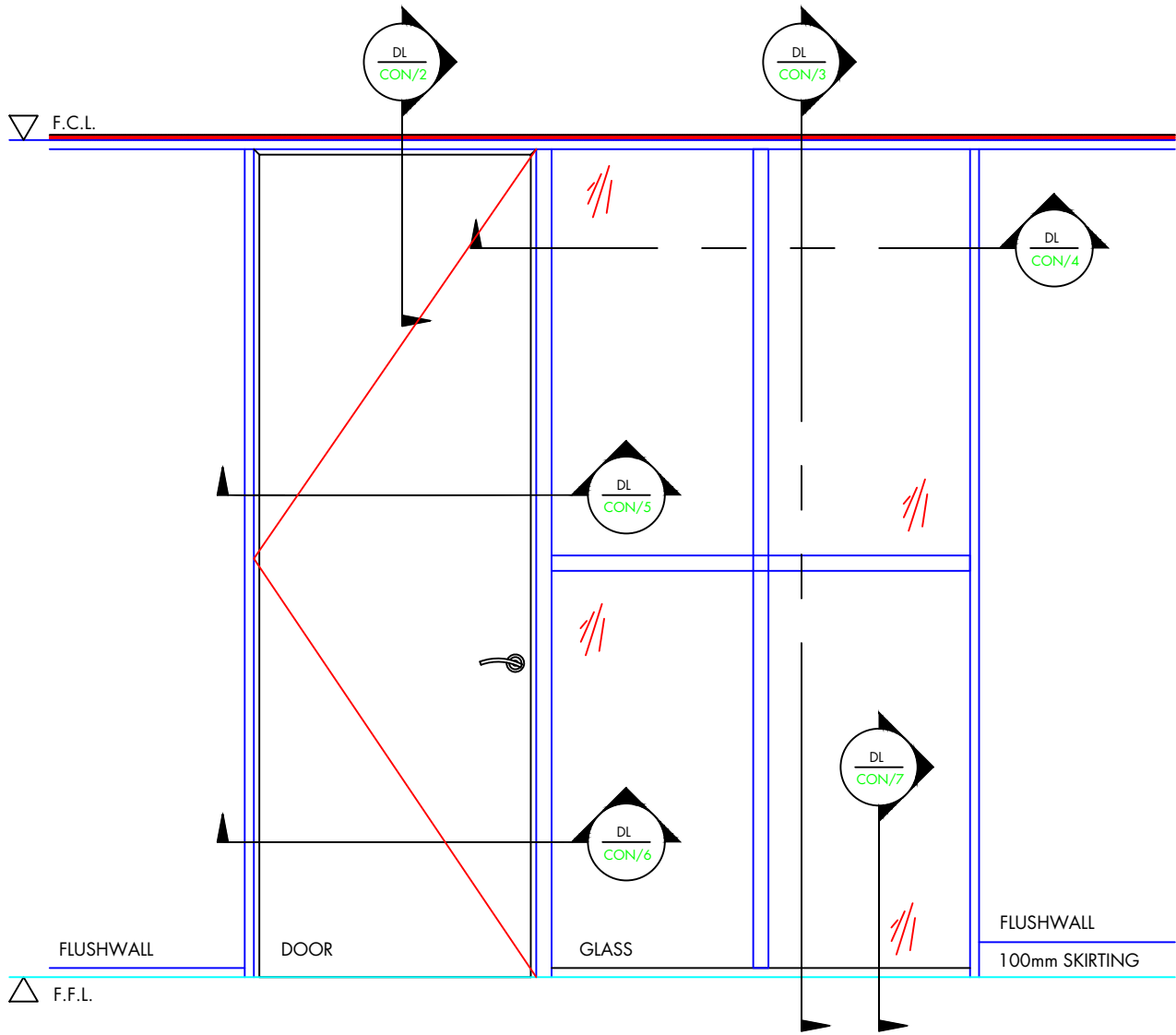

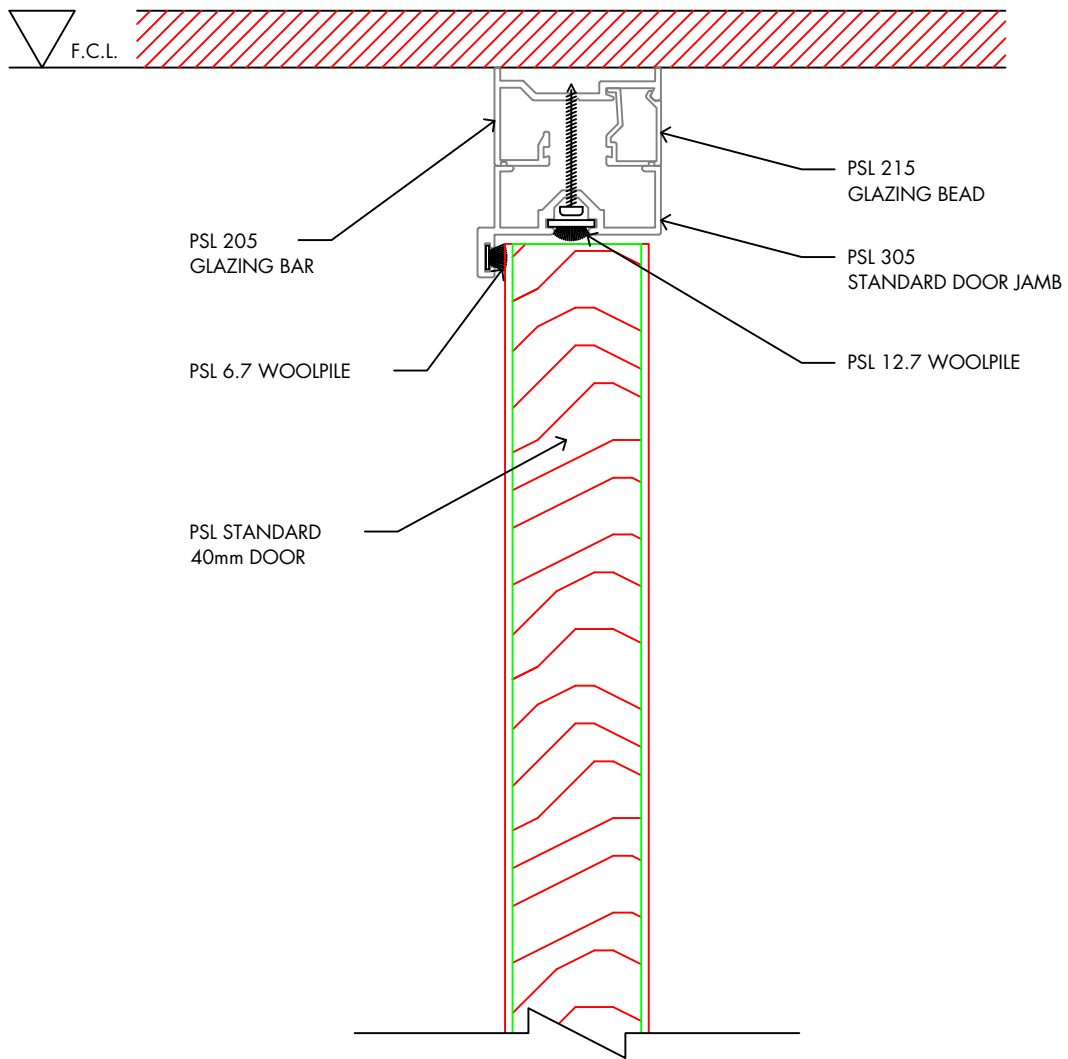

NOTE: WHERE SEISMIC BRACING IS
REQUIRED, AUTEX PSL RECOMMENDS USING
PSL 400 / 205 / 215

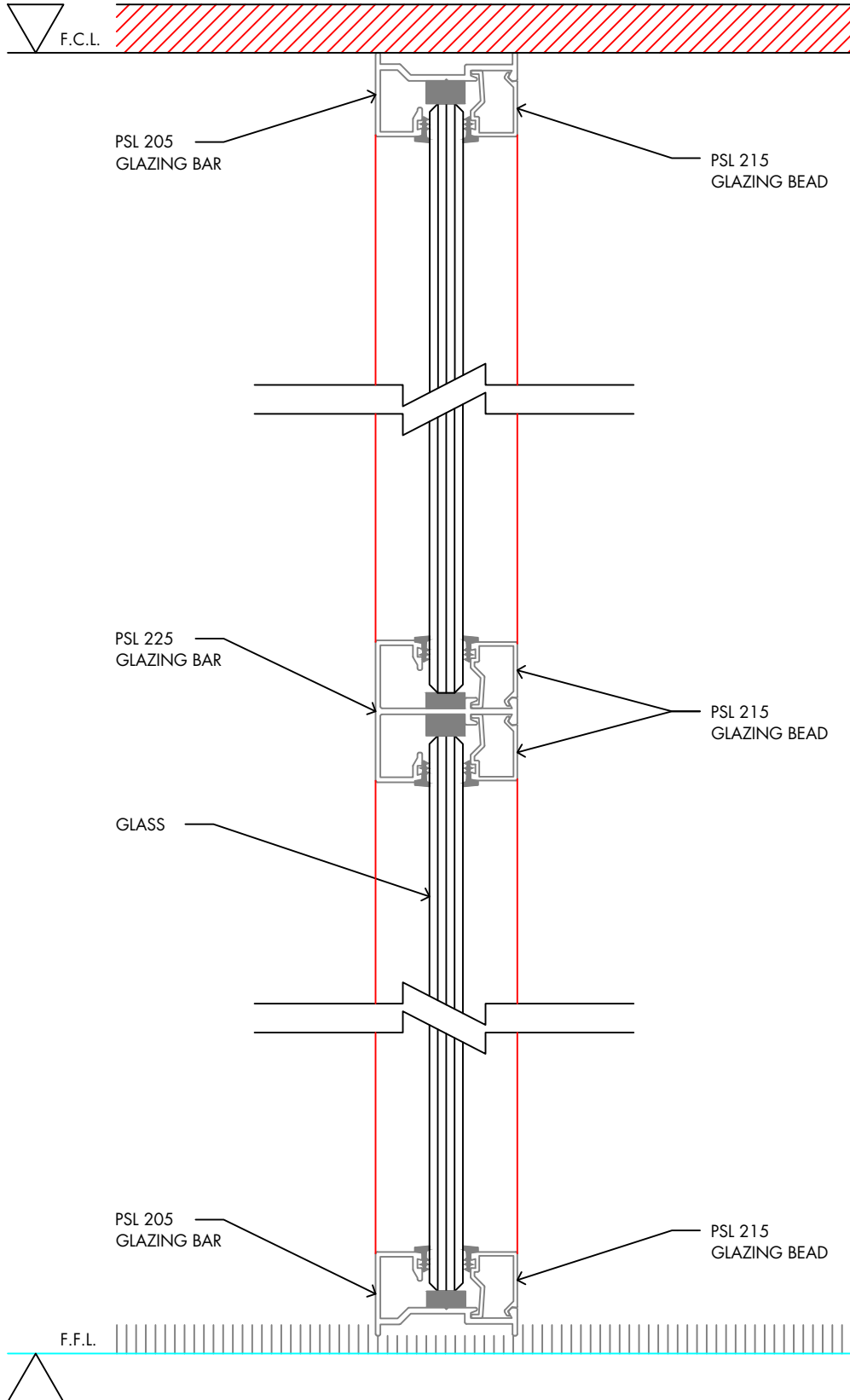

64mm Steel Stud, Solid Door, Pillar Post, Glazing

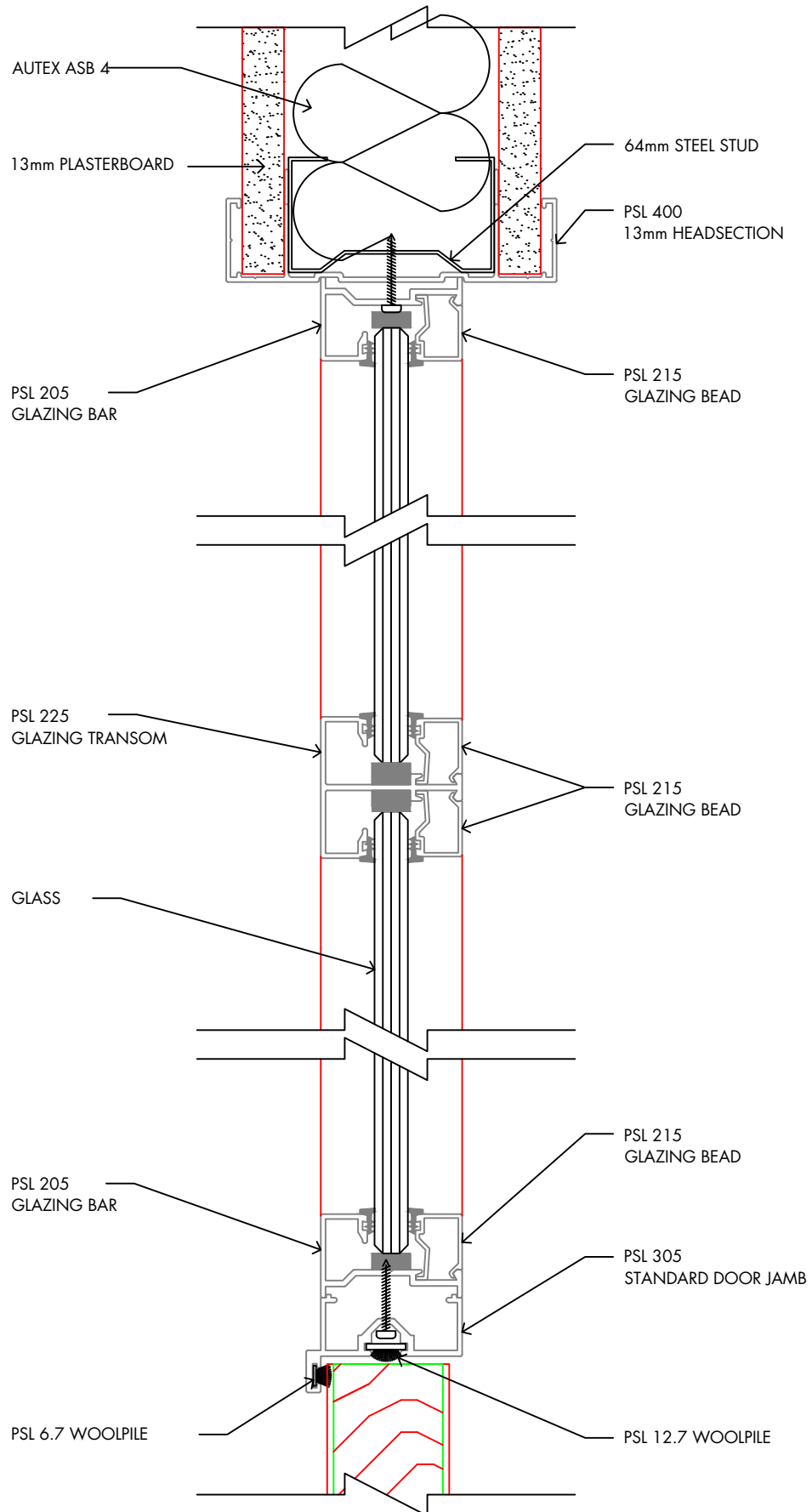

Solid Door, Glazing with Mullion, 64mm Steel Stud

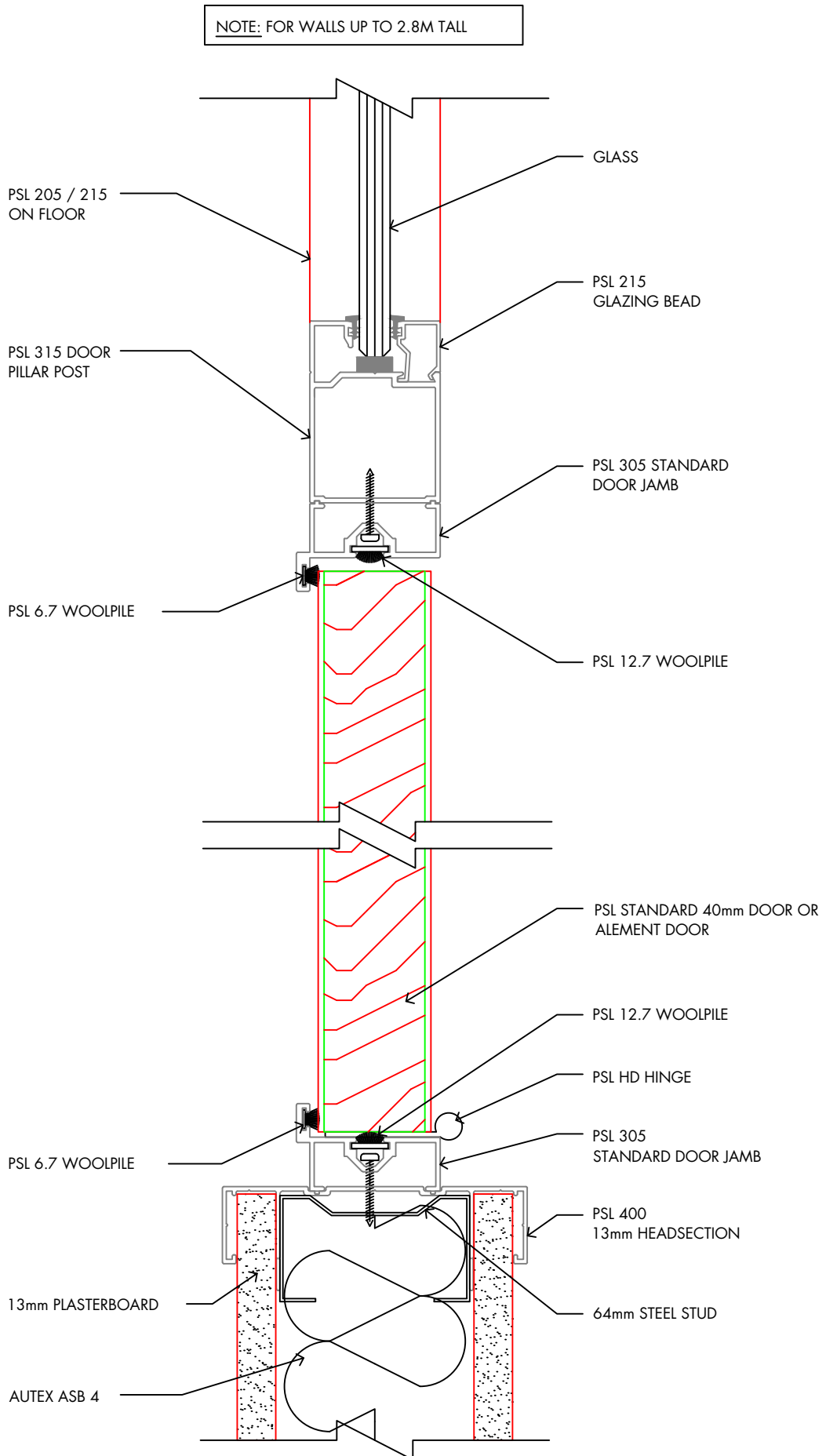

NOTE: FOR WALLS UNDER 2.3M TALL

